

Atelier

by Elizabeth Medley

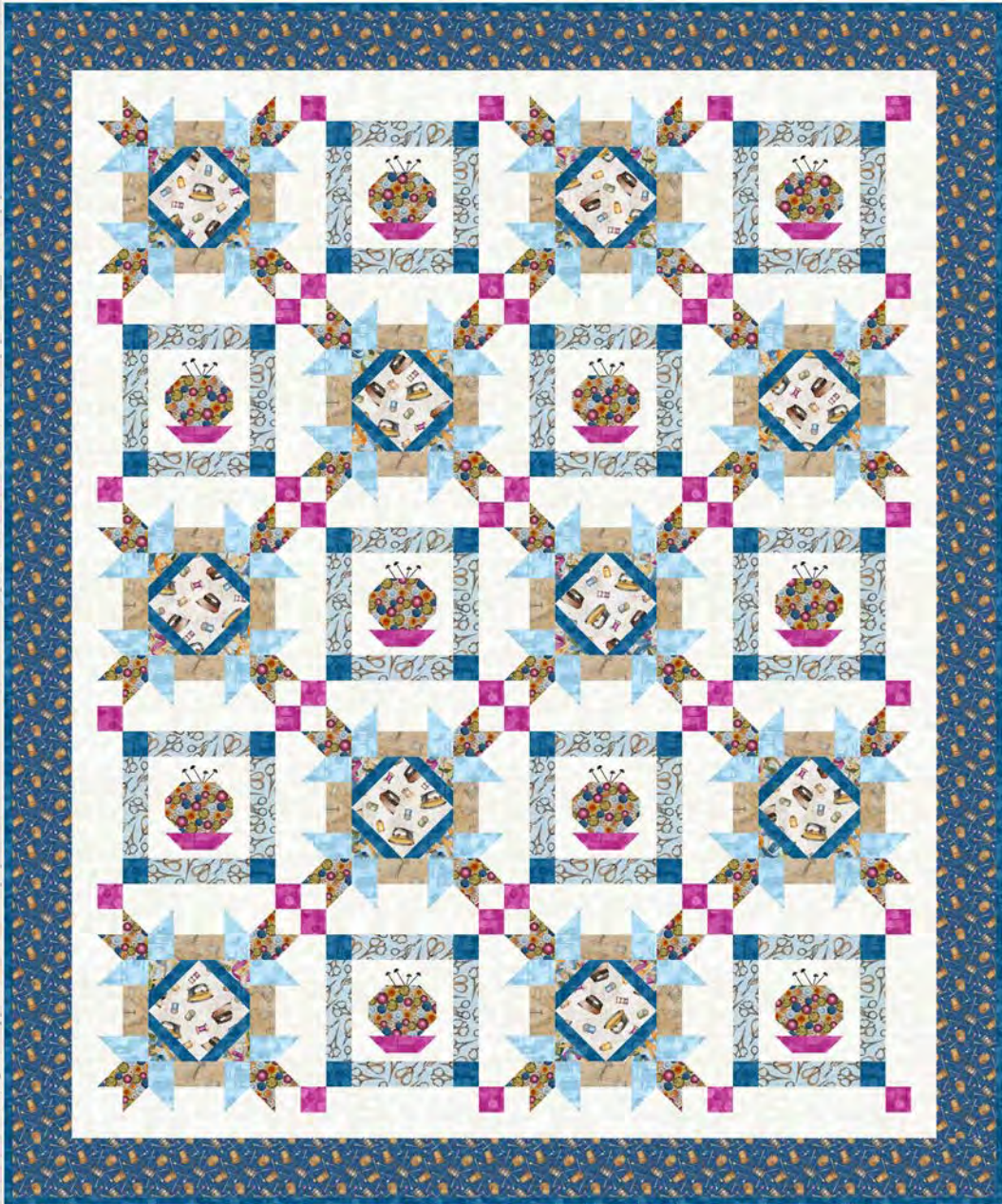

Quilt design by Denise Russell.

Quilt size: 58" x 70"

Skill Level: Intermediate

Blank Quilting Corporation
49 West 37th Street ♦ New York, NY 10018
Tel: 800-294-9495 ♦ Fax: 212-679-4578
www.blankquilting.net

facebook

Free Project
NOT FOR RESALE

Atelier - Fabrics in the Collection



2599P-35 Sewing Boutique
24" Panel - Tan



2597-41 Stripe - Ivory



2590-35 Dresses Bags
and Shoes in Blocks - Tan



2591-35 Tossed Sewing
Items - Tan

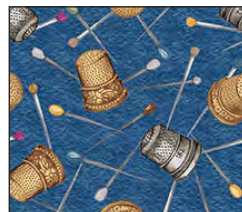

2592-77 Tossed Thim-
bles and Pins - Dk. Blue



2593-41 Tossed Sewing
Machines - Ivory



2594-11 Tossed
Scissors - Lt. Blue



2595-41 Tossed Irons
and Thread - Ivory



2596-77 Buttons
Dk. Blue



2598-11 Measuring
Tape - Lt. Blue

Selected fabrics from the
Jot Dot Collection



9570-09
Marshmallow



9570-11
Lt. Blue



9570-22
Fuchsia



9570-75
Ocean

Materials

Yardages and cutting instructions are based on 42" of usable fabric width.

1/8 yard 9570-99 Jot Dot - Black
1/4 yard 9570-22 Jot Dot - Fuchsia
1/3 yard 2591-35 Tossed Sewing Items - Tan
1/3 yard 2598-11 Measuring Tape - Lt. Blue
1/2 yard 9570-11 Jot Dot - Lt. Blue
1/2 yard 2594-11 Tossed Scissors - Lt. Blue
1/2 yard 2595-41 Tossed Irons & Thread - Ivory
5/8 yard 2596-77 Buttons - Dk. Blue
7/8 yard 2592-77 Tossed Thimbles & Pins - Dk. Blue
1-1/8 yards 9570-75 Jot Dot - Ocean
2-3/8 yards 9570-09 Jot Dot - Marshmallow
3-7/8 yards 2593-41 Tossed Sewing Machines - Ivory for backing
66" x 78" piece of Air Lite® Colour Me 100% Cotton batting
Fusible web

Cut Fabrics

Note: All strips are cut across the width of the fabric (WOF) from selvage to selvage unless otherwise indicated.

From 9570-99 Jot Dot – Black:

*Cut forty pins using templates.

From 9570-22 Jot Dot – Fuchsia:

*Cut two 1-1/2" x WOF strips. Sub-cut ten 1-1/2" x 4-1/2" strips.

*Cut two 2" x WOF strips.

From 2591-35 Tossed Sewing Items – Tan:

*Cut four 2" x WOF strips.

From 2598-11 Measuring Tape - Lt. Blue:

*Cut three 2-1/2" x WOF strips. Sub-cut forty 2-1/2" squares.

From 9570-11 Jot Dot - Lt. Blue:

*Cut four 3-1/2" x WOF strips. Sub-cut eighty 2" x 3-1/2" strips.

From 2594-11 Tossed Scissors - Lt. Blue:

*Cut seven 2" x WOF strips.

From 2595-41 Tossed Irons & Thread – Ivory:

*Cut two 6-1/2" x WOF strips. Sub-cut ten 6-1/2" squares.

From 2596-77 Buttons - Dk. Blue:

*Cut two 2-3/8" x WOF strips. Sub-cut twenty 2-3/8" squares.

*Cut two 3-1/2" x WOF strips. Sub-cut forty 2" x 3-1/2" strips.

*Cut one 4-1/2" x WOF strip. Sub-cut ten 3-1/2" x 4-1/2" rectangles.

From 2592-77 Tossed Thimbles & Pins - Dk. Blue:

*Cut seven 4" x WOF strips for border 2.

From 9570-75 Jot Dot – Ocean:

*Cut two 2" x WOF strips.

*Cut four 3-1/2" x WOF strips. Sub-cut forty 3-1/2" squares.

*Cut seven 2-1/2" x WOF strips for binding.

From 9570-09 Jot Dot – Marshmallow:

*Cut two 1" x WOF strips. Sub-cut ten 1" x 6-1/2" strips.

*Cut three 1-1/2" x WOF strips. Sub-cut sixty 1-1/2" squares.

*Cut twenty-seven 2" x WOF strips.

- Save fifteen strips for the strip sets.

- Sub-cut (200) 2" squares.

- Sub-cut ten 2" x 6-1/2" strips.

*Cut two 2-3/8" x WOF strips. Sub-cut twenty 2-3/8" squares.

*Cut one 4-1/2" x WOF strip. Sub-cut twenty 1-1/2" x 4-1/2" strips.

*Cut six 2" x WOF strips for border 1.

Assemble Blocks

Note: Measurements include 1/4" seam allowances. Sew with right sides together unless otherwise stated. If no direction is specified, press the seam toward the darker fabric.

1. Draw a diagonal line from corner to corner on the wrong side of (120) 2" 9570-09 Jot Dot – Marshmallow squares. Noting the line orientation and with right sides together, layer a marked Marshmallow square on the left short end of a 2" x 3-1/2" 2596-77 Buttons

- Dk. Blue strip and stitch on the drawn line. Trim 1/4" away from the seam line and press open. Repeat to make twenty 2" x 3-1/2" units. Make another set of twenty units with a different line orientation, as shown below.

Repeat this step with the 2" x 3-1/2" 9570-11 Jot Dot - Lt. Blue strips and the remaining 2" 9570-09 Jot Dot - Marshmallow squares to make forty units each of the different line orientations (*figure 1*).

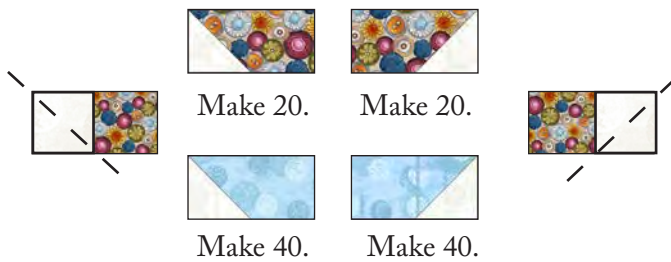

Figure 1 – Make 120 assorted 2" x 3-1/2" units.

2. Draw a diagonal line from corner to corner on the wrong side of twenty 2-3/8" 9570-09 Jot Dot - Marshmallow squares. With right sides together, layer the marked Marshmallow squares atop the 2-3/8" 2596-77 Buttons - Dk. Blue squares. Stitch 1/4" from each side of the diagonal line, cut on the drawn line, press each unit open with seams toward the darker fabric, and trim dog ears. Make a total of forty 2" half-square triangles (HST).

Sew a 2" 9570-09 Jot Dot - Marshmallow square to the HST as shown below, making twenty 2" x 3-1/2" units of each type. Press the seams toward the Marshmallow squares. Sew the units to the matching Step 1 strips to make twenty 3-1/2" corner units of each type (*figure 2*). Press the seams in one direction.

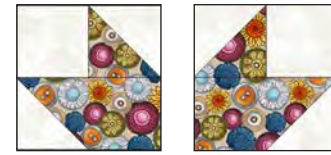
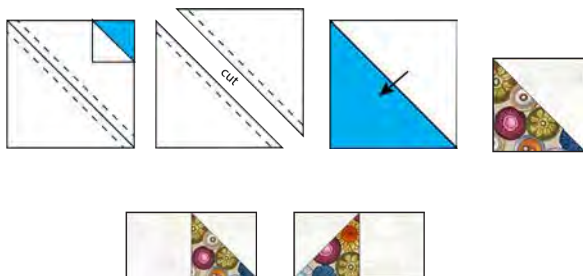

Figure 2 - Make (20) 3-1/2" units.

3. Sew a 2" 2591-35 Tossed Sewing Items - Tan strip to a 2" 9570-09 Jot Dot - Marshmallow strip. Press the seam toward the darker fabric. Repeat to make four strip sets. Cross-cut the strip sets into forty 3-1/2" segments. Noting orientation, sew a Step 1 Lt. Blue unit to the left and one to the right of each segment. Press the seams away from the center and save twenty units for the next step. Noting orientation, sew a Step 2 corner unit to the left and one to the right of the remaining units to make twenty 3-1/2" x 12-1/2" rows (*figure 3*). Press the seams toward the center.

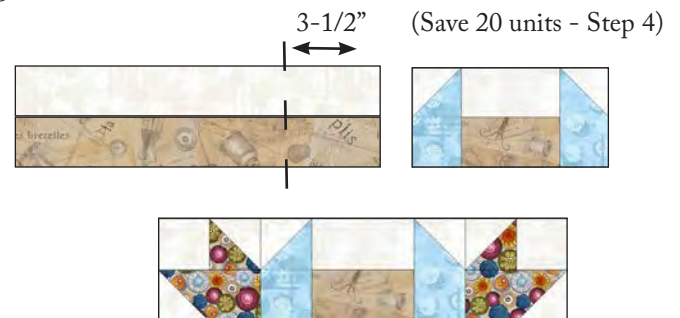

Figure 3 – Make 20 rows.

4. Draw a diagonal line from corner to corner on the wrong side of the 3-1/2" 9570-75 Jot Dot - Ocean squares. With right sides together, place one marked Ocean square on a corner of one 6-1/2" 2595-41 Tossed Irons & Thread - Ivory square and stitch on the drawn line. Repeat with the opposite corner of the same square. Trim seam allowances to 1/4" and press open. Repeat with the other square corners (this is the Stitch and Flip technique). Similarly, sew the 2-1/2" 2598-11 Measuring Tape - Lt. Blue squares to each corner of the units to make ten 6-1/2" center units. Sew a Step 3 unit to opposite sides of the center units and press the seam away from the center (*figure 4, next page*). The center rows measure 6-1/2" x 12-1/2".

Atelier - Quilt 2

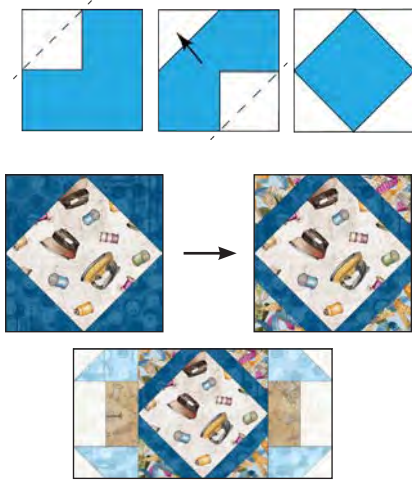

Figure 4 – Make (10) 6-1/2" x 12-1/2" rows.

5. Noting orientation, sew one Step 3 row to the top and one to the bottom of the Step 4 center rows to make ten 12-1/2" blocks (figure 5). Press the seams away from the center.



Figure 5 – Make (10) 12-1/2" blocks.

6. Using the same Stitch and Flip technique of Step 4, sew the 1-1/2" 9570-09 Jot Dot – Marshmallow squares to the corners of the 3-1/2" x 4-1/2" 2596-77 Buttons - Dk. Blue rectangles to make ten 3-1/2" x 4-1/2" units. Repeat with the remaining 1-1/2" Marshmallow squares and the 1-1/2" x 4-1/2" 9570-22 Jot Dot – Fuchsia strips. Sew the Fuchsia strips to the bottom of the Dk. Blue rectangles to make ten 4-1/2" units (figure 6). Press the seams away from the center.

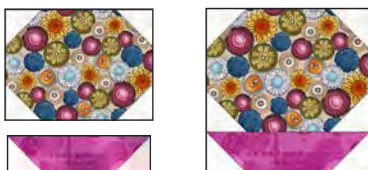

Figure 6 – Make (10) 4-1/2" units.

7. Sew a 1-1/2" x 4-1/2" 9570-09 Jot Dot – Marshmallow strip to opposite sides of the Step 6 units. Press the seams away from the center. Sew one 2" x 6-1/2" Marshmallow strip to the top and one 1" x 6-1/2" Marshmallow strip to the bottom of each unit and press the seams away from the center to make ten 6-1/2" center blocks (figure 7).



Figure 7 – Make (10) 6-1/2" units.

8. Sew seven 2" 9570-09 Jot Dot – Marshmallow strips to seven 2" 2594-11 Tossed Scissors - Lt. Blue strips as in Step 3 to make seven strip sets. Cross-cut the strip sets into forty 6-1/2" segments. Noting fabric orientation, sew one segment to opposite sides of the Step 7 units (figure 8). Press the seams away from the center to make the center rows. Save twenty segments for the next step.



Figure 8

9. Make two strip sets as in Step 3 with the 2" 9570-09 Jot Dot – Marshmallow and 2" 9570-75 Jot Dot – Ocean strips, and cross-cut the strip sets into forty 2" segments. Repeat with the 2" Marshmallow and the 2" 9570-22 Jot Dot – Fuchsia strips. Sew together one Ocean and one Fuchsia segment to make a 3-1/2" corner unit. Press the seams open. Make a total of forty units. Noting fabric orientation, sew a corner unit to opposite sides of the remaining Step 8 segments to make twenty 3-1/2" x 12-1/2" rows (figure 9). Press the seams toward the center.



Figure 9 – Make 20 rows.

10. Sew a Step 9 row to the top and one to the bottom of the Step 8 center rows to make ten 12-1/2" blocks (figure 10). Press the seams in one direction.

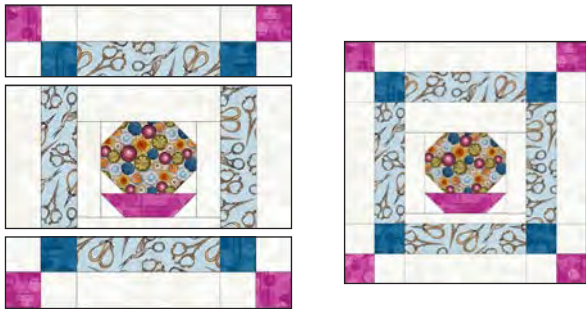

Figure 10 – Make (10) 12-1/2" blocks.

11. Place the pin shapes onto a lightbox or windowpane. Layer the fusible web onto them and trace them forty times. Cut each shape 1/8" outside the outline and fuse to the wrong side of the 9570-99 Jot Dot – Black fabric. Cut on the outline and remove the paper backing. Position appliqué shapes on the top of the 'pincushions' and fuse them according to the manufacturer's instructions (figure 11). Machine appliqué using matching thread and a straight stitch to secure the shapes in place.



Figure 11

Assemble Quilt Top

12. Following the quilt photo for block placement, lay out five rows of four blocks each. Sew the blocks

together in each row, then matching adjacent seams, sew the rows together in order.

13. For border 1, join the six 2" 9570-09 Jot Dot – Marshmallow strips together end to end using diagonal seams. Measure the vertical length of the quilt top through the center and cut two border strips that length. Sew one strip to each side of the quilt top and press the seams toward the border strips. Measure the width of the quilt top through the center. Cut two border strips that length and sew one to the top and one to the bottom. Press the seams toward the borders.

14. Repeat Step 13 with the seven 4" 2592-77 Tossed Thimbles & Pins - Dk. Blue strips to make and add border 2.

Finishing

15. Create a quilt sandwich with the batting between the quilt top and the backing. Pin or baste layers together, mark the quilting design, and quilt by hand or machine. When quilting is complete, remove pins or basting, and trim batting and backing even with raw edges of the quilt top.

16. Join the seven 2-1/2" 9570-75 Jot Dot – Ocean binding strips together end to end using a diagonal seam to make one long strip. Fold in half lengthwise and press. Sew binding to the edges of the quilt, mitering corners, and overlapping ends. Fold binding to the back of the quilt and stitch it in place by hand to finish.

Atelier - Quilt 2

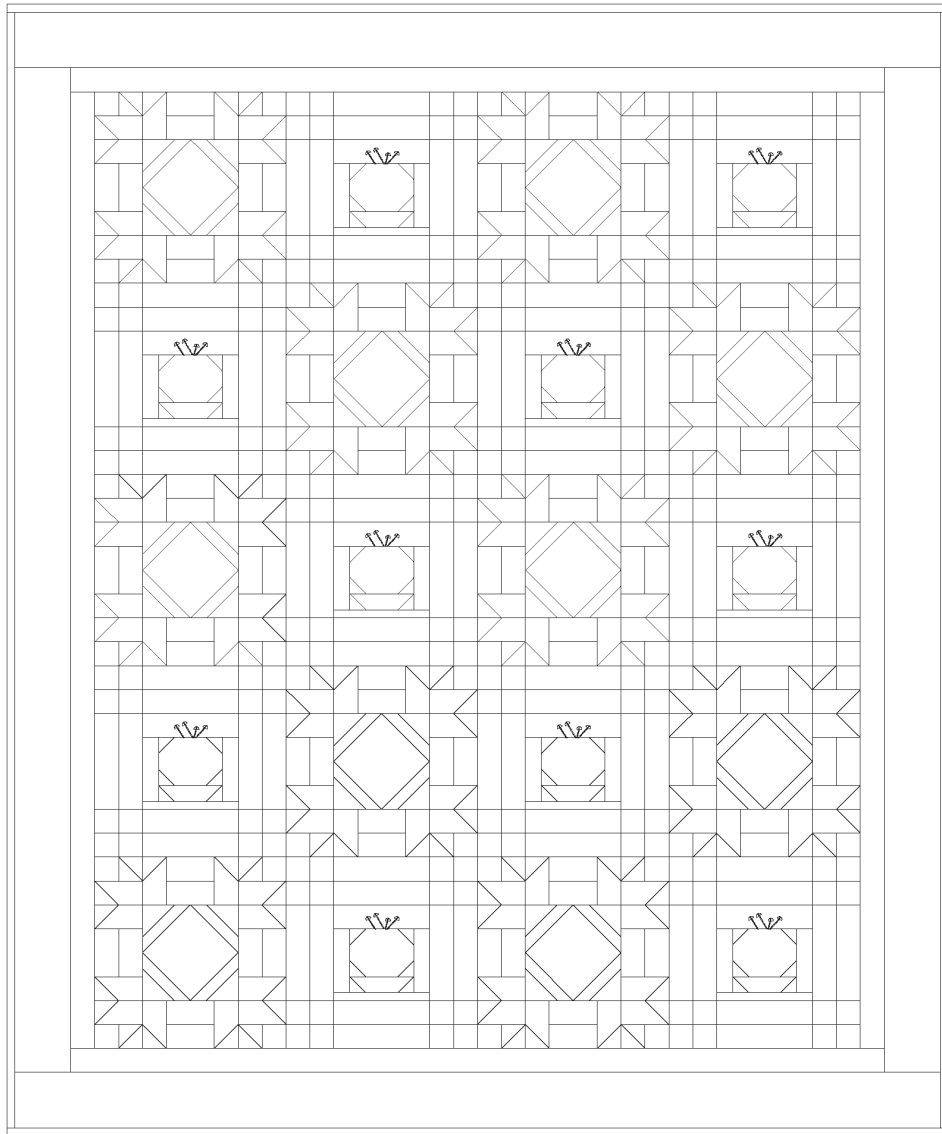

Quilt Diagram



Pin templates

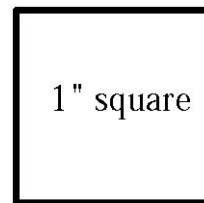

1" square